



OWNERS MANUAL

FOR PROFESSIONAL SNOW CONE MACHINE

MODEL:

SNOW BANK

Snow Cone Machine

PART NUMBER:

71000

INCLUDED:

OPERATING INSTRUCTIONS

SCHEMATICS

WIRING DIAGRAMS

PARTS LIST

WARRANTY INFORMATION

OPERATING INSTRUCTIONS

1. Install the **Pusher** by placing the hinge in the housing on top of the horn and inserting the bolt and tightening the nut.
(Item 7006 see diagram on page 4)
2. Install the **Drain Hose** by sliding one end on the drain spout and putting the other end in a collection container (not included).
(Item 7022 see diagram on page 4)
3. Plug the machine into a properly grounded 120 volt power supply. Do not use an un-grounded adapter or extension cord. It is important that the machine remains grounded during operation.
4. Open the Pusher Assembly and fill the Horn with the desired amount of either cube or chunk ice (chunks cannot exceed 3” in diameter). Do not overfill the Horn Assembly. Close the Pusher Assembly once you have the desired amount of ice in the Horn.
(Item 7005 see diagram on page 4)
5. Press and hold the rocker switch to activate the cutting head while applying downward pressure to the Pusher.
(Item 7015 see diagram on page 4)
6. Once the desired amount of ice is crushed, release the switch to turn of the motor and cutting head. The power switch is spring loaded so that it cannot be left in the ON position for safety purposes.
7. Scoop the crushed ice into a serving container and press the exposed ice in the container into the shaper attached to the ceiling of the cabinet. This will create a rounded top to the snow cone for ideal presentation. ***We recommend you use Benchmark USA Six-ounce Snow Cone Cups (Part# 72501) and Snow Cone Dipper (Part# 72305)***
8. Pour or pump snow cone syrup onto the finished cone. (a maximum of two ounces of syrup is recommended for a 6 oz. serving of ice). ***We recommend you use Benchmark USA pump (Part# 72301) along with Benchmark USA snow cone syrups (Part#'s 72001 – 72012).***
9. Repeat steps 4-8 for multiple batches.

CLEANING THE MACHINE

1. Remove all of the residual ice from the horn and collection tray. Operate the motor for a minimum of 30 seconds to remove any water that may have accumulated on the cutting head.
2. Unplug the machine from the power source and with a clean cloth wipe down the ice horn (caution: the cutting blades are sharp), the pusher, outside of the horn assembly, collection tray and glass panels.
3. The collection Tray and Service Door are removable for sink or dishwasher cleaning.
4. Only use cleaning products that are approved for food-zone applications on any of the surfaces of the machine that can touch the food product.

ADJUSTING/REPLACING CUTTING BLADES

1. Unplug the machine from the power source.
(Item 7017 see diagram on page 4)
2. Put the pusher in the open position and reach into the horn and rotate the head (caution: the blades are sharp) until the two allen screws on the cutting head collar are exposed through the dispensing chute on the ceiling of the cabinet.
(Item 7007 see diagram on page 4)
3. Using a 3mm hex wrench, loosen both set-screws (do not remove completely).
4. Slide the cutting head assembly off of the motor shaft and remove through the horn.
(Item 7007 see diagram on page 4)
5. **To Adjust the Blades**, loosen both screws on the blade and slide it to the desired depth. The less blade that is exposed will provide finer shaved ice and the more blade exposed will provide coarser ice.
(Item 7008 see diagram on page 4)
6. **To Replace the Blades**, Remove both screws from each blade and remove the old blades. Re-install the new blades and tighten all of the screws.
7. Re-install the finished cutting-head assembly by reversing instructions 2-4 and re-tightening the two allen screws on the cutting head collar. Make sure the two allen screws are tightening against the flat side of the motor shaft.

ASSEMBLY

(complete parts list on page 5)

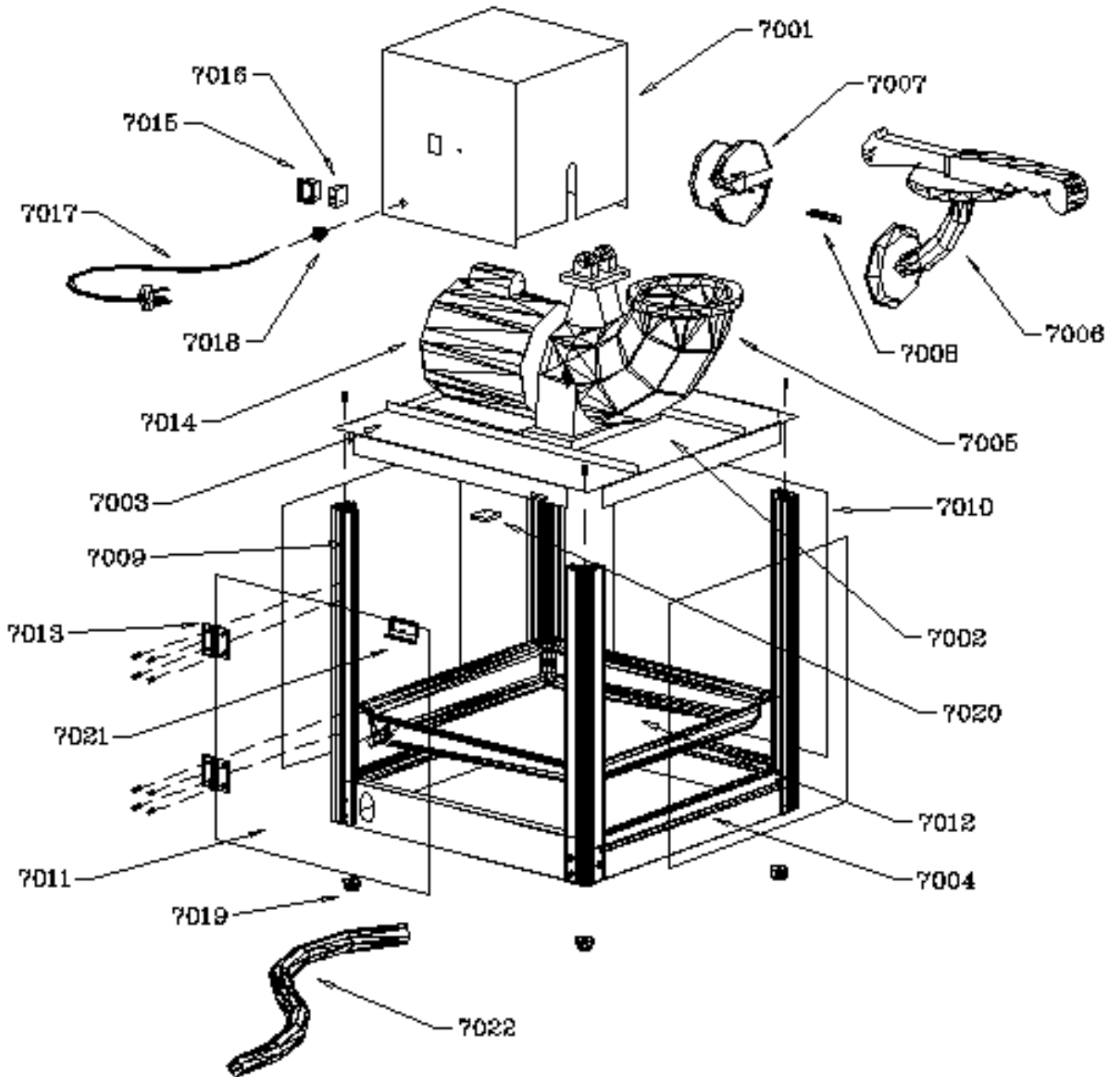

WIRING DIAGRAM

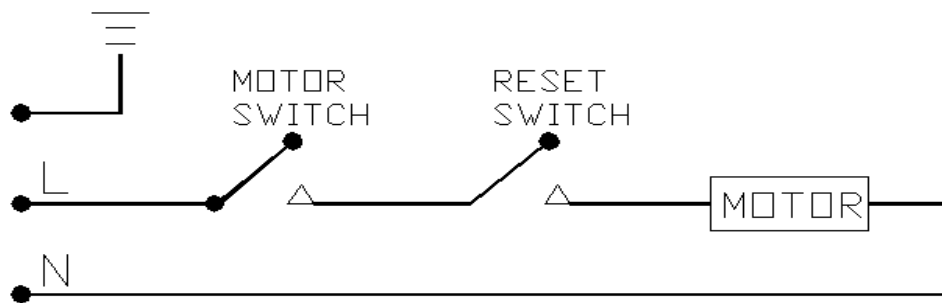
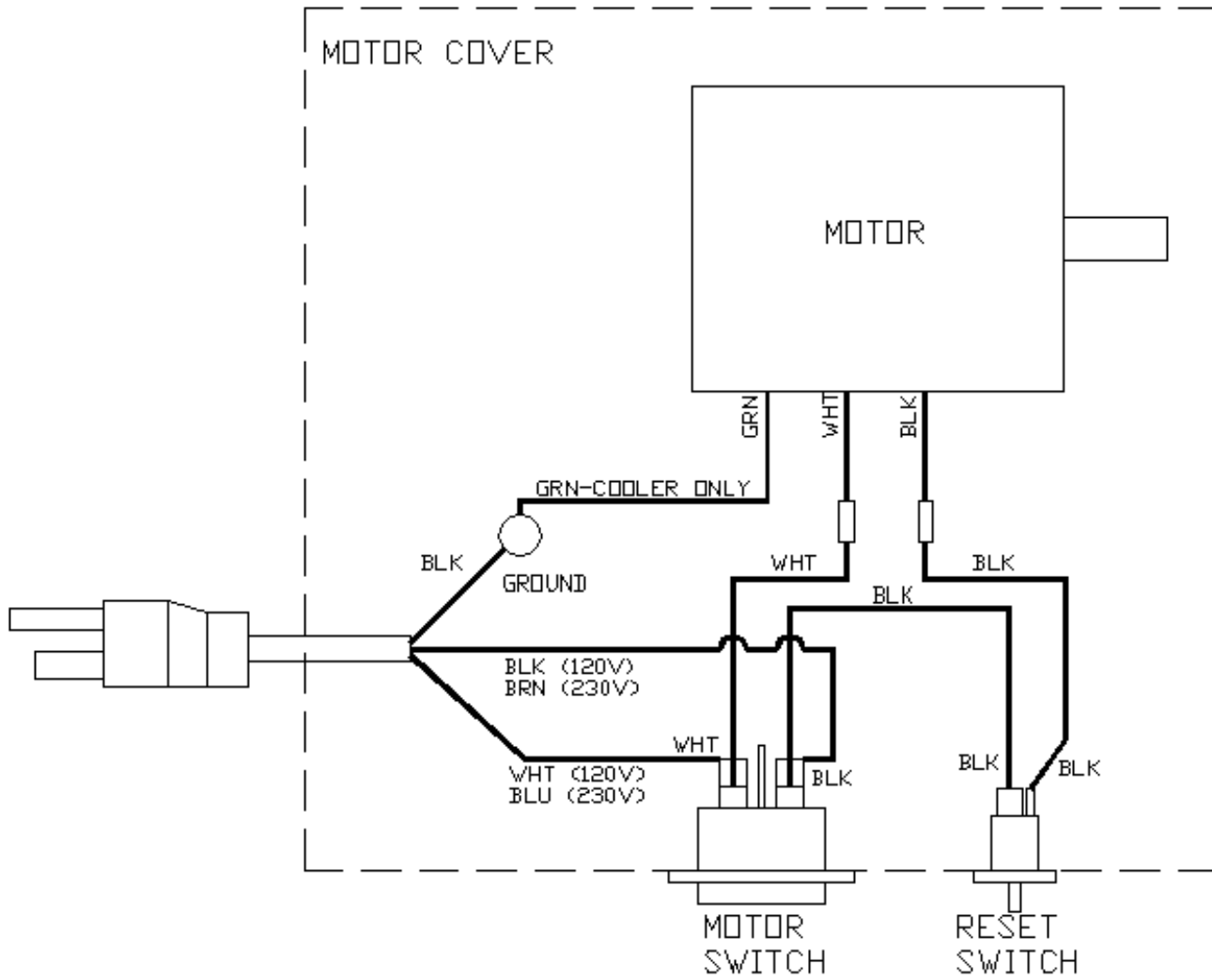

ELECTRICAL SCHEMATIC

MANUAL RE-SET BUTTON

Your new Benchmark USA “Snow Bank” ice shaver and snow cone machine is equipped with a manual Re-Set button to prevent injury. In the event the motor should jam, you must re-set the button before restarting the motor. When the motor jams, the machine will stop and you will not be able to activate the motor with the power switch. To re-activate the machine:

1. Release the power switch.
2. Push and release the Re-Set button
3. Push and hold the power switch to restart the motor.

If the motor does not re-start:

1. Unplug the machine from the power source.
2. Remove anything that is jammed in the horn
(Caution: The blades are sharp)
3. Plug the machine back into the power source.
4. Push and release the Re-Set button.
5. Push and hold the power switch.

ELECTRICAL REQUIREMENTS

This product requires a properly grounded 120 volt power supply with a minimum of a 15 amp circuit. The “Snow-Bank” snow cone machine draws 5.3 amps at maximum capacity and depending on what other electrical items you have on the same circuit, you may exceed the circuit capacity.

SPECIFICATIONS

Voltage	120 volts
Amps	5.3 amps
Horsepower	1/3 hp
RPM	1725 rpm
Capacity	500 lbs/hour

PARTS LIST

P/N	Description
7001	Motor Housing Cover
7002	Motor Support
7003	Chassis
7004	Base
7005	Horn Assembly
7006	Pusher Casting
7007	Cutting Head
7008	Cutting Blades (2)
7009	Corner Post
7010	Glass Panel
7011	Door
7012	Collection Tray
7013	Hinge Set
7014	Motor - Snow Bank
7015	Power Switch
7016	Re-set Button
7017	Power Cord
7018	Grommet
7019	Rubber foot
7020	Door Magnet
7021	Handle for Door
7022	Drain Hose
7022	Drain Hose

To Order Parts Contact:

Benchmark USA, Inc.

P.O. Box 475

Ames, IA 50010 USA

Tel: 515-232-5500

Fax: 515-232-5505

Email: parts@benchmarkusainc.com



Three Year Warranty

THE WARRANTY:

Benchmark USA warrants the original purchaser of new food equipment manufactured by Benchmark USA to be free from defects in material or workmanship from the date of the original purchase for a period of three years.

WHO IS COVERED BY THIS WARRANTY:

The original purchaser who has provided proper proof of the original retail purchase and all other requested information.

WHAT IS WARRANTIED:

The obligation of Benchmark USA under this warranty is limited to the replacement of any parts or components that in the opinion of Benchmark USA are defective, F.O.B. the factory, or at any other location that Benchmark USA may designate.

WHAT VOIDS THE WARRANTY:

1. Any piece of equipment that has been installed, operated or maintained inconsistently with Benchmark USA operating instructions.
2. Any part or component that has been modified, changed or altered from its original configuration.
3. Any electrical component that has been damaged due to submergence in any liquid.
4. Any part or component that has been subject to abuse, misuse, neglect or accidents.

EXTENT OF WARRANTY:

Any defective component, part or assembly returned to Benchmark USA will be replaced by Benchmark USA. Benchmark USA will not be responsible for any expenses incurred by the customer under the terms of this warranty, nor shall it be responsible for any damages either consequential, special, contingent, or otherwise; or expenses or injury arising directly or indirectly from the use of a Benchmark USA product. Any component, part or assembly returned to Benchmark USA must be returned at the customers expense along with proof of purchase. Benchmark USA reserves the right to determine whether the terms of this warranty have been properly complied with. In the event that the terms are not complied with, Benchmark USA shall be under no obligation to honor this warranty.